

# 6 Pointed star box - base

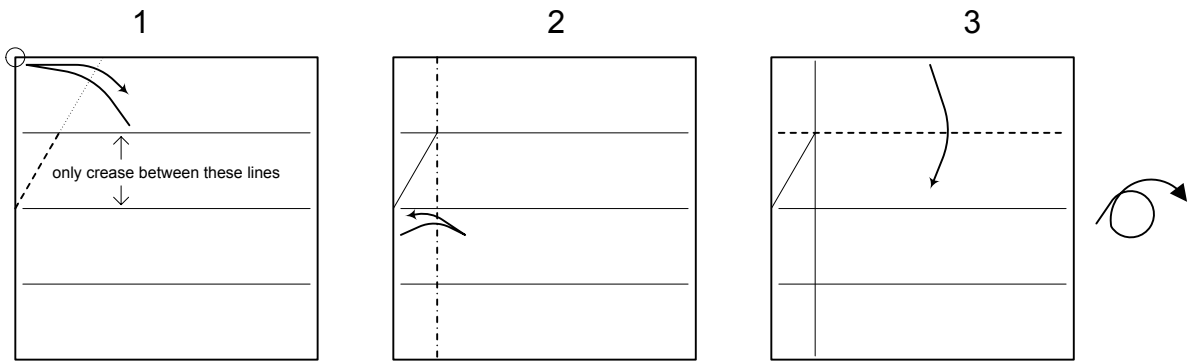

Begin with a square creased into quarters horizontally

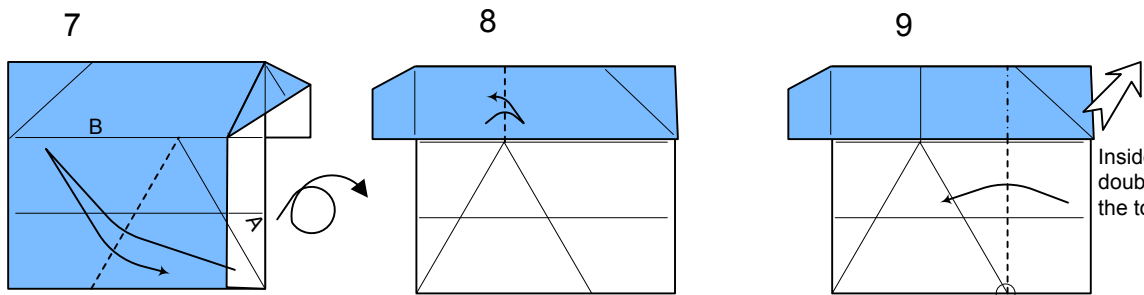
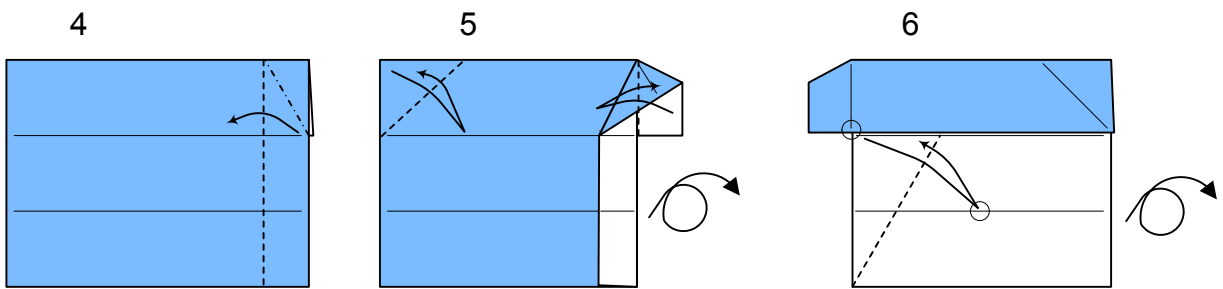

Inside reverse fold the double layer by lifting the top flap

Crease so line A runs parallel to line B

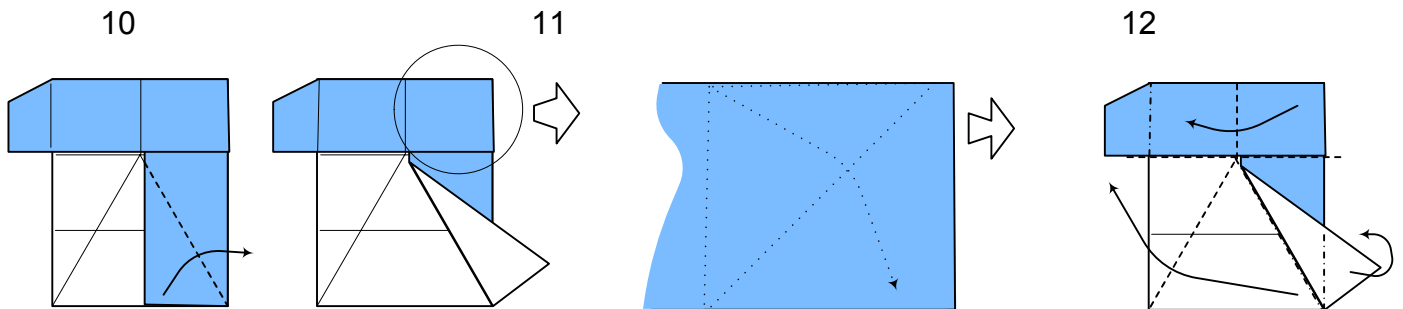

Make the whole thing 3D

Valley fold the 2 inner layers. It helps to lift the top layer out of the way first.

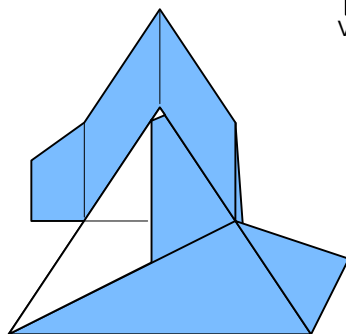

Make 5 more

# 6 Pointed star box - base

## Assembly

13

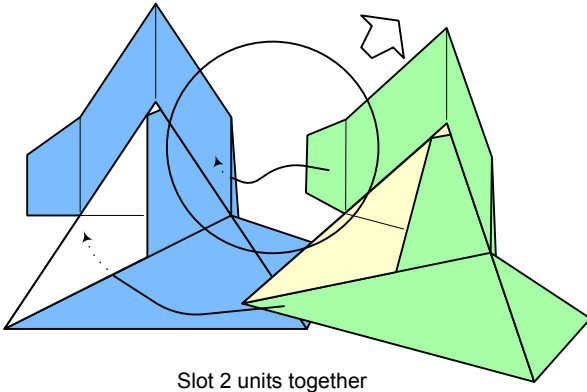

14

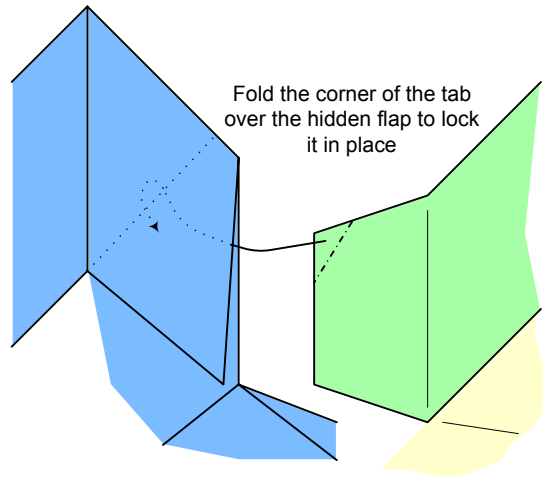

15

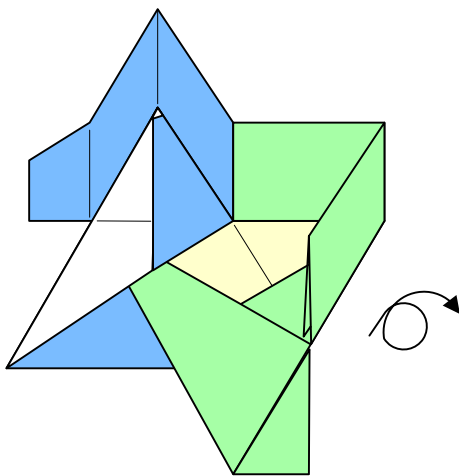

16

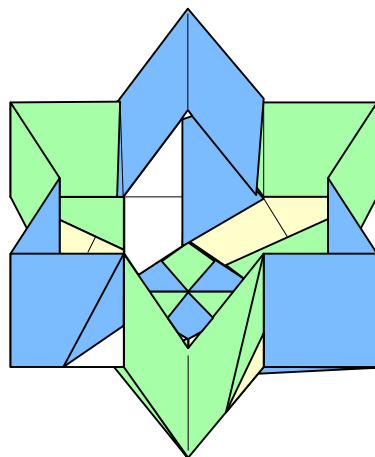
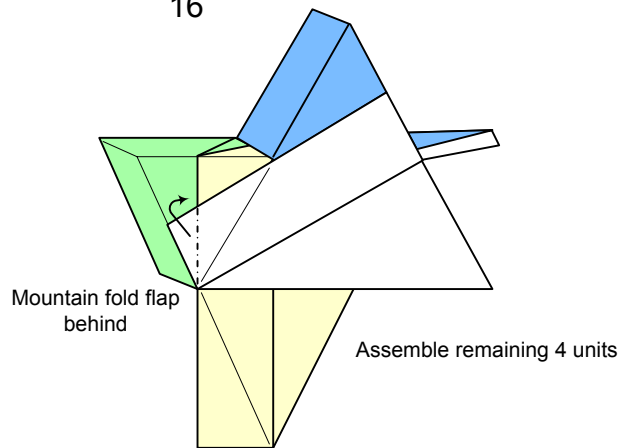

# 6 Pointed star box - lid

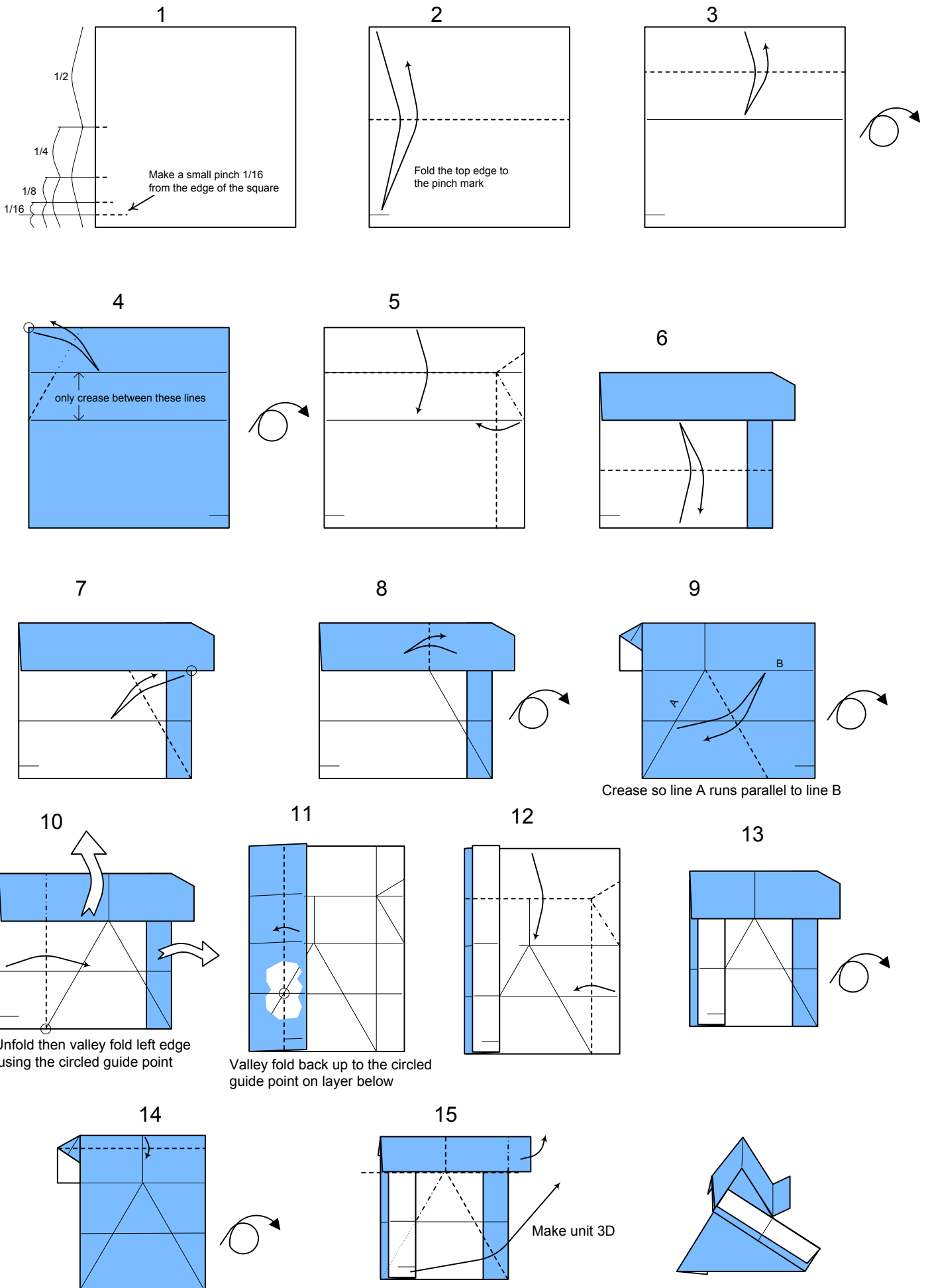

# 6 Pointed star box - lid

## Assembly

16

Insert tab into pocket  
(mate the two turned over top edges).

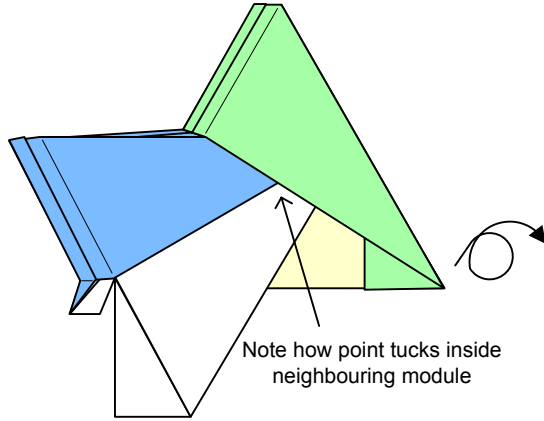
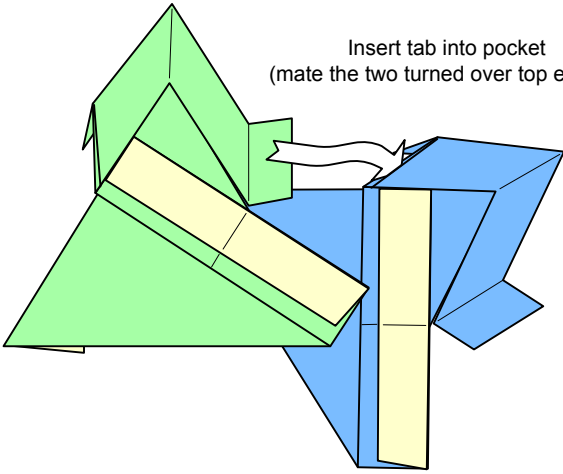

17

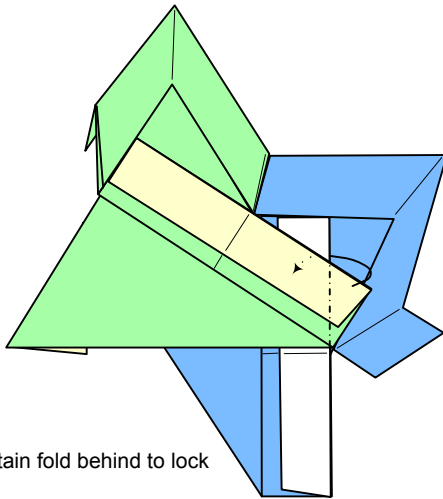

Mountain fold behind to lock

.....Assemble remaining 4 units

